

**30th Annual N.A.T.A.
Workshop and Clinical Symposium**



**June 17-20, 1979
Stouffers Riverfront Towers**



30th NATA Annual Meeting and Clinical Symposium

St. Louis June 16-20, 1979

National Convention Chairman

Fred Hoover, A.T.,C.
Clemson University
Clemson, S.C. 29631

Program Chairman

Tim Kerin, A.T.,C.
University of Tennessee
Knoxville, TN 37916

1979 St. Louis Chairman

Gene Smith, A.T.,C.
Memphis State University
Memphis, TN 38152

Student Trainer Coordinator

Darcy Shriver, A.T.,C.
Eastern Kentucky University
Richmond, KY 40475

Host Trainer

Bobby Barton, A.T.,C.
Eastern Kentucky University
Richmond, KY 40475

Banquet Coordinator

Fred Hoover, A.T.,C.
Bobby Barton, A.T.,C.

Public Information Director

Dick O'Connor
St. Louis University
St. Louis, MO 63108

President's Reception Coordinator

Bruce Melin, A.T.,C.
Washington University
St. Louis, MO 63130

PR Coordinator

George Camp, A.T.,C.
Middle Tennessee State University
Murfreesboro, TN 37132

Student Banquet Coordinator

Jeff Daniel, A.T.,C.
Austin Peay State University
Clarksville, TN 37040

Entertainment Chairman

Ron Dunn, A.T.,C.
Western Kentucky University
Bowling Green, KY 42101

Registration Liaison

Mayfield Armstrong, A.T.,C.
Tulane University
New Orleans, LA 70118

Audio-Visual Committee Chairman

Tom Simmons, A.T.,C.
Murray State University
Murray, KY 42071

N.A.T.A. Office - Joliette

Thursday	- 6:00 PM - End of Convention
Friday	- 9:00 AM - 5:00 PM
Saturday	- 9:00 AM - 8:00 PM
Sunday - Tuesday	- 7:30 AM - 6:00 PM
Wednesday	- 7:30 AM - 12:00 Noon

N.A.T.A. Convention Office & Press Room - Hickok

Friday - Sunday	- 9:00 AM - 5:00 PM
Monday - Tuesday	- 8:00 AM - 5:00 PM
Wednesday	- 8:00 AM - 12:00 Noon

Registration - Downstairs Lobby

Saturday	- 10:00 AM - 8:00 PM
Sunday	- 7:30 AM - 6:00 PM
Monday	- 7:15 AM - 5:00 PM
Tuesday	- 7:30 AM - 12:00 Noon

Exhibit Hours - Exhibit Areas

Saturday	- 5:00 PM - 7:00 PM
Sunday - Tuesday	- 8:30 AM - 5:00 PM
Exhibits Close Tuesday	- 5:00 PM

National Business Meeting - Illinois-Missouri

Monday - 11:00 AM - 1:00 PM

District Meetings

Saturday - 6:00 PM - 8:00 PM

District 3 - Spirit of St. Louis

District 9 - Lewis

Monday - 5:00 PM - 6:00 PM

District 1	- Illinois
District 2	- Illinois
District 3	- Atrium C
District 4	- Meramec
District 5	- Missouri
District 6	- Lewis & Clark
District 7	- Spirit of St. Louis
District 8	- Daniel Boone
District 9	- Mississippi
District 10	- Atrium B

Big 10 Meeting - Clark

Saturday - 6:00 PM - 8:00 PM

Committee Meetings

Board of Directors - Eugene Field

Professional Education Committee

Thursday - 3:00 PM Atrium B

Friday - 8:00 AM - Atrium B

Saturday - 8:00 AM - 12:00 Noon Atrium B

Program Directors Council

Saturday - 12:00 Noon - 6:00 PM Atrium A, B, C

Joint Commission on Safeguards in Athletics

Saturday - 8:00 AM - Frontier

Sunday - 8:00 AM - 12:00 Noon Frontier

Placement Committee

Monday - 8:00 AM - 10:00 PM Atrium A

Certification Committee

Saturday - 6:00 PM - Carondelet

Certification Examination

Sunday - 8:00 AM - 12:00 Noon Daniel Boone

- 8:00 AM - 4:00 PM Spirit of St. Louis

Outpost

LaCleda

Carondelet

Atrium A, B, C

N.F.L. Physicians and Trainers

Saturday - 12:00 Noon - 6:00 PM Clark

(Trainers)

Sunday - 8:00 AM - 12:00 Noon Lewis & Clark

(Physicians & Trainers)

Sunday - 12:00 Noon - 8:00 PM Lewis & Clark

(Physicians)

N.F.L. Dentists -

To Be Announced

N.B.A. Physicians & Trainers -

To Be Announced

N.H.L. Physicians & Trainers -

To Be Announced

State Licensure Meeting for Athletic Trainers

Monday - 2:00 PM - 4:00 PM Spirit of St. Louis

Entertainment Schedule

Student Trainer Banquet

Sunday - 6:00 PM - 8:00 PM **Meramec**

Awards Banquet

Tuesday - 7:30 PM **Illinois-Mississippi**
Tickets at Entertainment Desk

June 16

Saturday P.M.

Grant's Farm Tour - Sponsor: Anheuser Busch
Buses leave Stouffer's at 12:15 - 1:15 - 2:15
Buses furnished by Seattle Seahawks
Pick up tickets at Entertainment Desk

Anheuser Busch Hospitality Room-Welcome Athletic Trainers
Sponsor: Anheuser Busch
8:00 P.M. to 10:00 P.M. Meramec Room Stouffer's Inn
Admission by Registration Name Tag

June 17

Sunday A.M.

Cramer Run - 7:30 A.M. Sponsor: Cramer Products
Meet in Hotel Lobby

Sunday P.M.

St. Louis Zoo - (Spouses and Children Only)
Must Register at Entertainment Desk

Shriners Circus - Busch Memorial Stadium - 7:45 P.M.
Sponsor: Monsanto Corporation
Pick up Tickets at Entertainment Desk

June 18

Monday A.M.

Six Flags over Mid-America
Tickets sold at special reduced rate at Entertainment Desk

N.A.T.A. Wives Continental Breakfast
Sponsor: N.A.T.A.
9:30 A.M. Lewis & Clark Stouffer's Inn
Tickets at Entertainment Desk

Monday P.M.

N.F.L. Cocktail Party
Sponsor: National Football League
6:30 - 8:00 P.M.
By invitation only - Certified Trainers

June 19

Tuesday A.M.

F.C.A. Breakfast - 7:00 A.M.
Continental Breakfast Mississippi Room Stouffer's Inn
Sponsor: Max Pro, Dallas, Texas

Wives Outing to Missouri Botanical Gardens
Buses leave at 9:30 A.M.
Purchase Tickets at Entertainment Desk

Tuesday P.M.

1:00 - 5:00 P.M.

Families Choice - Popular attractions in St. Louis
St. Louis Gateway Arch
St. Louis Municipal Opera
Anheuser Busch Brewery Tour (For detailed information on
Old Courthouse each activity, please inquire
St. Louis Cathedral at Entertainment Desk)
St. Louis Sports Hall of Fame
St. Louis Art Museum
Shopping at the Malls

J & J Cocktail Party (Banquet Ticket Holders Only)
6:15 P.M. Mississippi Room Stouffer's Inn
Sponsor: Johnson & Johnson

Awards Banquet - 7:30 P.M.
Illinois & Mississippi Room Stouffer's Inn

Pre-Symposium & Workshop Sessions
Sunday June 17, 1979

9:00 A.M. - 12:00 Noon

Continuing Education

Session 1 - Illinois

Subject: Flexibility & Strengthening Exercises for Baseball

Bob Spackman, A.T.,C. - Southern Illinois University

Session 2 - Mississippi

Subject: Common Hand Injuries in Competitive Athletics

Barry Gainor, M.D. - St. Louis Medical School

Session 3 - Meramec

Subject: Adolescent Injuries in Competitive Athletics

Robert Burdge, M.D. - St. Louis Medical School

2:00 P.M. - 5:00 P.M. Schering Symposium

Mississippi - Illinois - Missouri

Subject: The Hand and Wrist

Vincent DiStefano, M.D.

Team Physician, Philadelphia Eagles

Pat Evans, M.D.

Team Physician, St. Louis Cardinals

James L. Ellsasser, M.D.

Team Physician, St. Louis Cardinals

John Omohundro, A.T.,C.

Head Trainer, St. Louis Cardinals

6:15 P.M. - 7:15 P.M. Panel Discussion

Missouri - Illinois - Mississippi

Subject: How to Live with Artificial Turf

Stanley Plagenhoff, Ph.D.

Amherst, Massachusetts

Eddie Lane, A.T.,C., Head Trainer

Dallas Independent School District

Roy Don Wilson, A.T.,C., Head Trainer

University of Southwestern Louisiana

N.A.T.A. Clinical Symposium & Workshop

Monday, June 18, 1979

8:15 A.M. - 8:30 A.M.

8:30 A.M. - 9:30 A.M. Meramec

Panel Discussion - Licensure

Moderator: Warren Morris, A.T.,C.
Head Trainer, University of Georgia
Roy Don Wilson, A.T.,C.
Head Trainer, University of Southwestern
Louisiana

Bob Behnke, A.T.,C.
Trainer, Indiana State University
Member, Joint Committee on Licensure

John Spiker, A.T.,C., L.P.T.
Head Trainer, West Virginia University
Member, Joint Committee on Licensure

9:30 A.M. - 10:00 A.M. Visit Exhibits

10:00 A.M. - 11:00 A.M. Meramec

Panel Discussion and Demonstration - Low Back Injuries in
Athletics

Jack Rockwell, A.T.,C.

James McMaster, M.D.

1:00 P.M. - 2:00 P.M. Lunch

2:00 P.M. - 3:00 P.M. Meramec

Discussion: Head and Neck Injuries

Joe Maroon, M.D.

3:00 P.M. - 3:30 P.M. Visit Exhibits

5:00 P.M. - 6:00 P.M.

District Meetings

District 1 Illinois

District 2 Illinois

District 3 Atrium C

District 4 Meramec

District 5 Missouri

Monday, June 18, 1979

8:15 A.M. - 8:30 A.M.

Illinois

Invocation and Opening Remarks

Bobby Barton, A.T.,C.

Head Trainer, Eastern Kentucky
University

Director, District 9; Host Trainer, 1979
N.A.T.A. Clinical Symposium & Workshop

Gene Smith, A.T.,C.

Head Trainer, Memphis State
University

Chairman, 1979 N.A.T.A. Clinical
Symposium & Workshop

Response:

Bill Chambers, A.T.,C.

President, N.A.T.A.

8:30 A.M. - 9:30 A.M.

Illinois

Low Back Problems in Athletics

James McMaster, M.D., Team Physician
University of Pittsburgh, PA

Jack Rockwell, A.T.,C., Associate Director,
Clinic for Sports Medicine, St. Francis
Hospital, San Francisco, CA

9:30 A.M. - 10:30 A.M.

Visit Exhibits

10:00 A.M. - 11:00 A.M.

Illinois

Head and Neck Injuries in Athletics

Joe Maroon, M.D., Team Neurosurgeon,
University of Pittsburgh; Consultant,
Pittsburgh Steelers, Pittsburgh, PA

11:00 A.M. - 1:00 P.M.

Illinois

National Business Meeting

1:00 P.M. - 2:00 P.M.

Lunch

2:00 P.M. - 3:00 P.M.

Illinois

Pharmacology and the Athlete's Performance

Martin L. Lambert, Ph.D., Chairman,
Board of Directors, American Apothe-
caries; Assistant Professors, Samford
University, Pharmacist, Knoxville, TN

3:00 P.M. - 3:30 P.M.

Visit Exhibits

3:30 P.M. - 4:30 P.M.

Illinois

Podiatrics and Today's Athlete

Steve Subotnick, D.P.M., M.S., Hayward,
CA

5:00 P.M. - 6:00 P.M.

District Meetings

District 6	Lewis & Clark
District 7	Spirit of St. Louis
District 8	Daniel Boone
District 9	Mississippi
District 10	Atrium B

Tuesday, June 19, 1979

8:30 A.M. - 9:30 A.M. Meramec

Use of Electro-Therapeutic Modalities in Athletics

Tab Blackburn, A.T.,C., L.P.T.
Physical Therapist, Columbus, GA

Jack Redgren, A.T.,C., L.P.T.
Head Athletic Trainer, Vanderbilt
University

9:30 A.M. - 10:30 A.M. Meramec

Demonstration-Discussion - Rehabilitation of the Lower Leg

James Andrews, M.D.

Tab Blackburn, A.T.,C., L.P.T.

10:30 A.M. - 11:00 A.M. Visit Exhibits

12:00 Noon - 1:30 P.M. Lunch

1:30 P.M. - 2:30 P.M. Meramec

Prevention of Heat Problems in Football

Chris Patrick, A.T.,C., Head Athletic
Trainer, University of Florida

Charlie Martin, A.T.,C., Head Athletic
Trainer, Northeast Louisiana University

2:30 P.M. - 3:00 P.M. Visit Exhibits

3:00 P.M. - 4:00 P.M. Meramec

Demonstration: Evaluation of the Injured Knee
and Rehabilitation

A. Brant "Pinky" Lipscomb, M.D.
Team Physician, Vanderbilt University

Leroy Mullins, A.T.,C.

3:00 P.M. - 4:00 P.M. Spirit of St. Louis

N.C.A.A. Drug Education Committee

Daniel F. Hanley, M.D., Student Health
Service, Bowdoin College, Brunswick, MA,
Former U.S. Olympic Team Physician

Gerald P. Sherman, Ph.D., University of
Toledo College of Pharmacy, Toledo, OH

4:00 P.M. - 5:00 P.M. **Spirit of St. Louis**

4:00 P.M. - 5:00 P.M. Meramec

"Tips from the Top"

Panel Discussion: No Topic - Free Discussion from Some
Elder Statesmen

Moderator: "Porky" Morgan, A.T.,C., Head Trainer
Kansas State University

Bob Bowman, A.T.,C., Former Head
Trainer, St. Louis Baseball Cardinals

"Whitey" Gwynn, A.T.,C., Former Head
Trainer, West Virginia University

Tuesday, June 19, 1979

8:30 A.M. - 9:30 A.M. Illinois

Foot and Ankle Problems in Athletics

James Andrews, M.D., Orthopedic
Consultant, Auburn University, Auburn,
AL

9:30 A.M. - 10:30 A.M. Illinois

Thermo-Regulatory System of the Female Athlete

Mimi Porter, A.T.,C., Head Women's
Athletic Trainer, University of
Kentucky, Lexington, KY

10:30 A.M. - 11:00 A.M. Visit Exhibits

11:00 A.M. - 12:00 Noon Illinois

Legal Liabilities of the Athletic Trainer

Richard T. Ball, Attorney, Phoenix, AZ

12:00 Noon - 1:30 P.M. Lunch

1:30 P.M. - 2:30 P.M. Illinois

Anterior Cruciate Insufficiency

William T. Youmans, M.D., Team
Orthopedist, University of Tennessee,
Knoxville, TN

Leroy Mullins, A.T.,C., Head Trainer,
University of Mississippi, Jackson, MS

2:30 P.M. - 3:00 P.M. Visit Exhibits

3:00 P.M. - 4:00 P.M. Illinois

Dermatological Problems in Athletics

Wilma Bergfield, M.D., Head of the
Dermatology Clinic, Cleveland Clinic,
Cleveland, OH

3:00 P.M. - 5:00 P.M. Free Communications

3:00 P.M. - 3:15 P.M. Control and Elimination of Staphylococcal
Infection in Athletics, Ivan E. Milton,
A.T.,C., Southwest Missouri State
University

3:15 P.M. - 3:30 P.M. The Effects of Ankle Taping on Triceps
Surae Force, John Shrader, A.T.,C.
Indiana University

3:30 P.M. - 3:45 P.M. Enlargement of the Blind Spot of Mariotte:
A Practical Index to Evaluate Post-
Concussive Status
Carl E. Nelson, A.T.,C., Colby College

3:45 P.M. - 4:00 P.M. Developing Post-Surgical Knee Strength:
The Daily Adjustable Progressive Resistive
Exercise (DAPRE) Technique Versus the
Delorme Technique,
Kenneth L. Knight, Indiana State
University

4:00 P.M. - 4:15 P.M. Isokinetic Leg Strength Characteristics of
Male and Female College Athletes,
Gil L. Etheridge, University of Kansas

4:15 P.M. - 4:30 P.M. Houstonic Medicine in Athletic Training,
Alan Peppard, SUNY - Brockport

4:30 P.M. - 4:45 P.M. Three Dimensional Kinematics of the
Taped Ankle,
Timothy Carr, Mayo Clinic

4:45 P.M. - 5:00 P.M. Isotonic VS Isokinetic: An Electro-
myographical Study of the Knee Extensor
Musculature, Alan H. Halling

Wednesday, June 20, 1979

9:00 A.M. - 10:00 A.M. Meramec

Demonstration: Hand and Wrist Injuries — Diagnosis, Special
Taping and Pads

Joe Gieck, A.T.,C., Ph.D., Head Athletic
Trainer, University of Virginia
Charlottesville, VA

William Wheeler, M.D., Team Physician,
University of Kentucky, Lexington, KY

10:00 A.M. - 11:00 A.M. Meramec

Hand and Wrist Injuries in Sports other than Football

Joe Gieck, A.T.,C., Ph.D.

William Wheeler, M.D.

12:00 Noon

Check Out Time — Have a Safe Trip Home

Wednesday, June 20, 1979

9:00 A.M. - 10:00 A.M. Illinois

Soft Tissue Injuries to the Shoulder

David Sisk, M.D., Team Physician,
Memphis State University,
Memphis, TN

Don Fauls, A.T.,C., Head Athletic
Trainer, Florida State University,
Tallahassee, FL

10:00 A.M. - 11:00 A.M. Illinois

Demonstration: Rehabilitation and Special Strappings of the
Shoulder

David Sisk, M.D.

Don Fauls, A.T.,C.

11:00 A.M. - 11:30 A.M. Illinois

1980 N.A.T.A. Symposium and Workshop, Philadelphia, PA

Ted Quendenfeld, A.T.,C., Associate
Director, Sports Medicine Clinic,
University of Pennsylvania

Joe Godak, A.T.,C., Assistant Trainer
West Chester State College

12:00 Noon Check Out Time — Have a Safe Trip Home

NOTES

1. The first part of the paper is devoted to a discussion of the general principles of the theory of the structure of the atom.

2. The second part of the paper is devoted to a discussion of the general principles of the theory of the structure of the atom.

3. The third part of the paper is devoted to a discussion of the general principles of the theory of the structure of the atom.

4. The fourth part of the paper is devoted to a discussion of the general principles of the theory of the structure of the atom.

NOTES

Meeting Level Floor Plan •

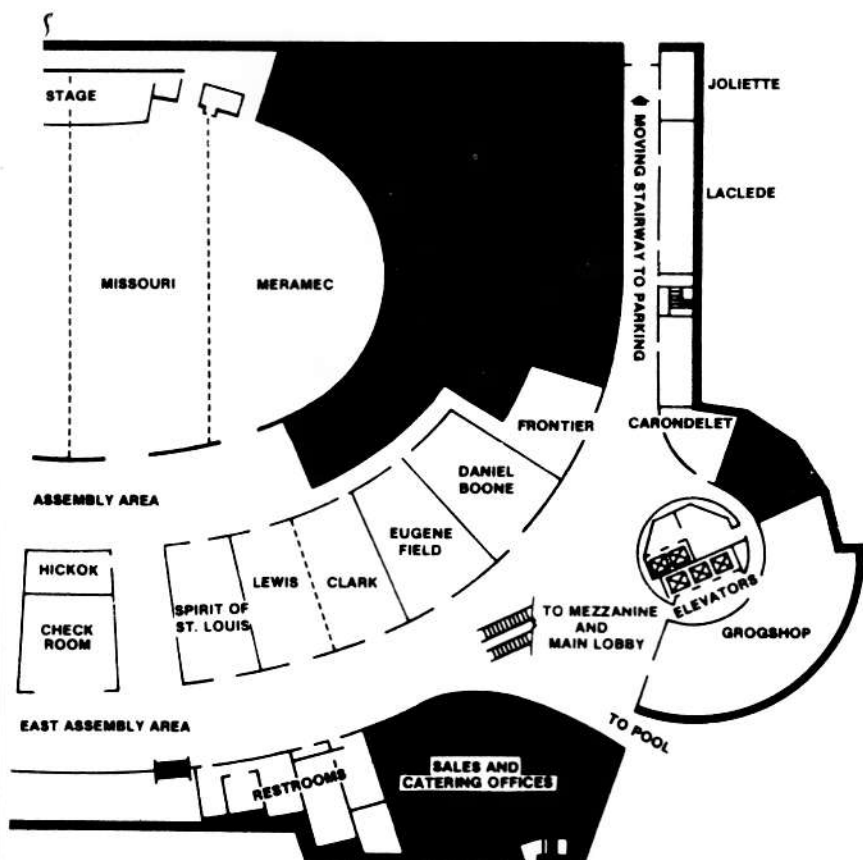

Stouffer's

RIVERFRONT TOWERS

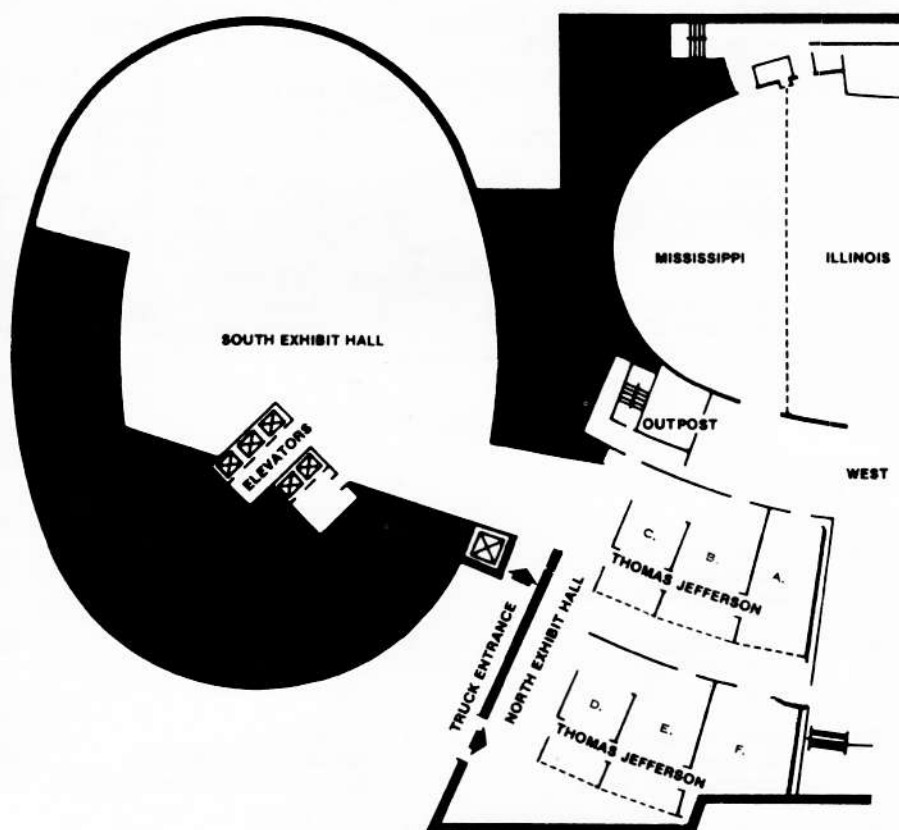

The National Athletic Trainers Association

President

William H. Chambers
Fullerton Junior College
Department of Athletics
Fullerton, California 92634

Executive Director

Otho Davis
Philadelphia Eagles
Veterans Stadium
Philadelphia, Pennsylvania 19148

District Directors

- | | | | |
|---------|--|----------|--|
| Dist. 1 | Wesley D. Jordan
University of Maine
Orono, Maine 04473 | Dist. 6 | Cash D. Birdwell
Southern Methodist University
Dallas, Texas 75222 |
| Dist. 2 | Richard F. Malacrea
Princeton University
Princeton, New Jersey 08540 | Dist. 7 | Troy Young
Arizona State University
Tempe, Arizona 85281 |
| Dist. 3 | J. Herman Bunch
3810 Merton Drive
Raleigh, North Carolina 27607 | Dist. 8 | Don Chu
California St. U. at Hayward
Hayward, California 94542 |
| Dist. 4 | Gordon Stoddard
University of Wisconsin
Madison, Wisconsin 53706 | Dist. 9 | Bobby Barton
Eastern Kentucky University
Richmond, Kentucky 40475 |
| Dist. 5 | Frank Randall
Iowa State University
Ames, Iowa 50011 | Dist. 10 | Larry Standifer
University of Oregon
Eugene, Oregon 97403 |

District Secretaries

- | | | | |
|---------|--|----------|--|
| Dist. 1 | Joseph Abraham
Hobart College
Geneva, New York 14456 | Dist. 6 | James Dodson
Midland High School
Midland, Texas 79701 |
| Dist. 2 | Joseph Abraham
Hobart College
Geneva, New York 14456 | Dist. 7 | Dale Mildenerger
Utah State University
Logan, Utah 84322 |
| Dist. 3 | Andy Clawsom
The Citadel
Charleston, S.C. 29409 | Dist. 8 | Jim Welsh
San Jose State University
San Jose State, California 95192 |
| Dist. 4 | Marjorie Albom
Indiana University
Bloomington, Indiana 47401 | Dist. 9 | Steve Moore
Tennessee Technological University
Cookeville, Tennessee 38501 |
| Dist. 5 | Sandy Miller
Northwest Missouri St.
University,
Maryville, Missouri 50011 | Dist. 10 | A. John Anderson
300 Metropole Bldg.
Seattle, Washington 98104 |

Audio-Visual Aids - Robert Burkhardt
Certification - Rod Moore
Drug Education - John Wells
Ethics - L.F. "Tow" Diehm
Grants and Scholarships -
W.E. "Pinky" Newell
History and Archives - Mike O'Shea
Honor Awards - George Sullivan
International Games - Frank George

Journal - Rod Compton
Membership - Bruce Melin
National Convention - Fred Hoover
Placement - Rodney Poindexter
Professional Education - Says "Bud" Miller
Career Information & Services -
Charles Demer
Public Relations - Richard Hoover
Research and Injury - John Powell